

Monthly Unsheltered Homeless Count

Regional Taskforce on the Homeless Methodology

2012 - 2017													
	Jan	Feb	Mar	Apr	May	June	July	Aug	Sept	Oct	Nov	Dec	Average
2012 Monthly Totals:	486	485	405	453	513	502	672	623	725	887	636	593	582
2013 Monthly Totals:	531	568	458	509	563	599	571	619	556	541	557	508	548
2014 Monthly Totals:	569	568	634	585	597	662	679	630	614	644	538	555	606
2015 Monthly Totals:	685	744	717	695	629	720	810	657	581	677	765	884	714
2016 Monthly Totals:	672	811	842	843	1148	1156	1162	1386	1140	1130	1170	1415	1073
2017 Monthly Totals:	882	1027	1105	875	892	1156	1100	1335	1275	1091	941	1012	1058
2018													
	*Jan	*Feb	*Mar	Apr	*May	June	*July	*Aug	*Sept	Oct	*Nov	*Dec	Average
East Village	495	474	594	502	523	459	621	582	501	504	473	482	517
City Center	123	156	128	111	180	118	139	146	129	104	146	147	136
Columbia	50	58	61	46	46	53	37	56	26	34	24	45	45
Marina	31	34	32	37	35	50	37	72	46	29	41	52	41
Cortez	61	56	72	44	52	40	47	54	32	16	46	40	47
Gaslamp	44	84	93	51	68	39	45	55	53	52	69	40	58
Monthly Totals:	804	862	980	791	904	759	926	964	787	739	799	806	843
**EAST VILLAGE BREAKOUT													
North East EV	58	68	86	75	75	73	102	78	90	60	55	78	75
North West EV	67	45	89	92	84	88	100	101	86	102	73	82	84
South East EV	334	361	361	294	320	265	385	360	299	307	219	288	316
South West EV	36	30	58	41	44	33	34	43	26	35	127	34	45
2019													
	*Jan	*Feb	Mar	*Apr	*May	*June	*July	Aug	*Sept	Oct	Nov	*Dec	
East Village	543	497	428	502	506	468	604	470	533	479	416	370	485
City Center	132	109	130	107	146	157	147	124	192	170	103	124	137
Columbia	53	43	33	55	61	61	52	46	49	67	38	41	50
Marina	57	49	30	33	38	35	36	39	40	31	33	20	37
Cortez	54	33	53	44	45	46	71	31	55	39	26	37	44
Gaslamp	59	68	59	36	65	54	52	61	77	61	62	35	57
Monthly Totals:	898	799	732	776	860	821	961	770	946	847	677	627	809
**EAST VILLAGE BREAKOUT													
North East EV	55	80	64	81	101	74	87	62	70	63	69	30	70
North West EV	96	98	83	94	60	72	94	74	94	98	38	115	85
South East EV	341	300	264	295	316	301	395	312	311	301	281	210	302
South West EV	51	19	17	32	30	21	28	22	59	18	29	15	28

Notes:

The preliminary methodology (shown in yellow) counted two individuals per tent and two individuals per vehicle.

On April 27, 2017, the Clean & Safe program adopted the counting methodology used by the Regional Task Force on the Homeless. Per the methodology (represented above by the dark green cells), Clean & Safe staff counted 1.75 individuals per visible tent/structure and 1.66 individuals per vehicle that showed clear signs of habitation.

In May 2018, the Regional Task Force on the Homeless updated the methodology for vehicles to 2.03 that shows clear signs of habitation (the methodology of 1.75 individuals per tent/structure remained the same). The Clean & Safe program implemented this methodology on May 31, 2018 (represented in orange).

* Denotes the months that The Downtown Fellowship of Ministries and Churches collaborated with us on the monthly homeless sleep count.

**East Village breakout areas include the following:

North East East Village is the area north of Market Street & east of Park Ave.

North West is the area north of Market Street & west of Park Ave.

South East is the area east of Park Ave. south of Market Street

South West is the area west of Park Ave. south of Market Street

East Village N 12AM-5AM



Downtown Fellowship of Churches & Ministries

Date: 12/19/19

Name: *Kristen Heston's*

Signature: *[Handwritten Signature]*

Temperature: 48°

Rain: Yes/No

Count Breakdown		Count	Value
		267	267
		7	14.21
		51	89.25
	Total		370.46

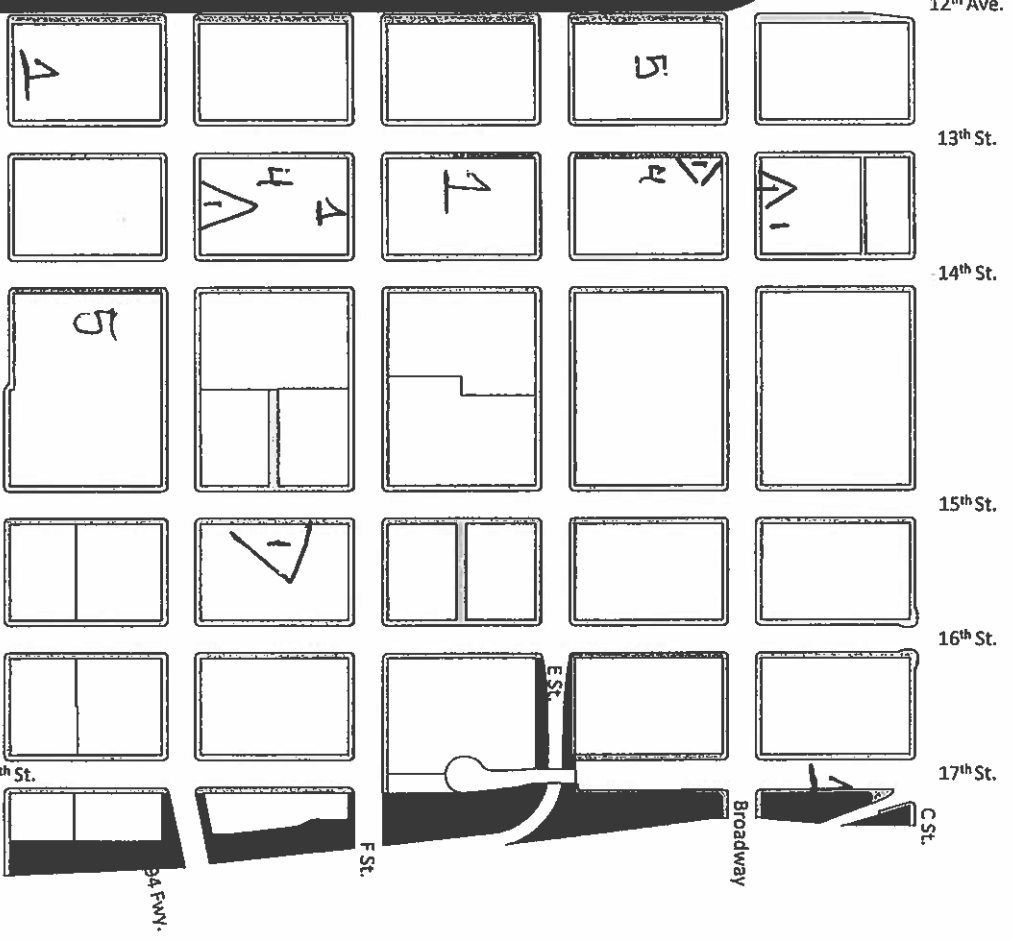
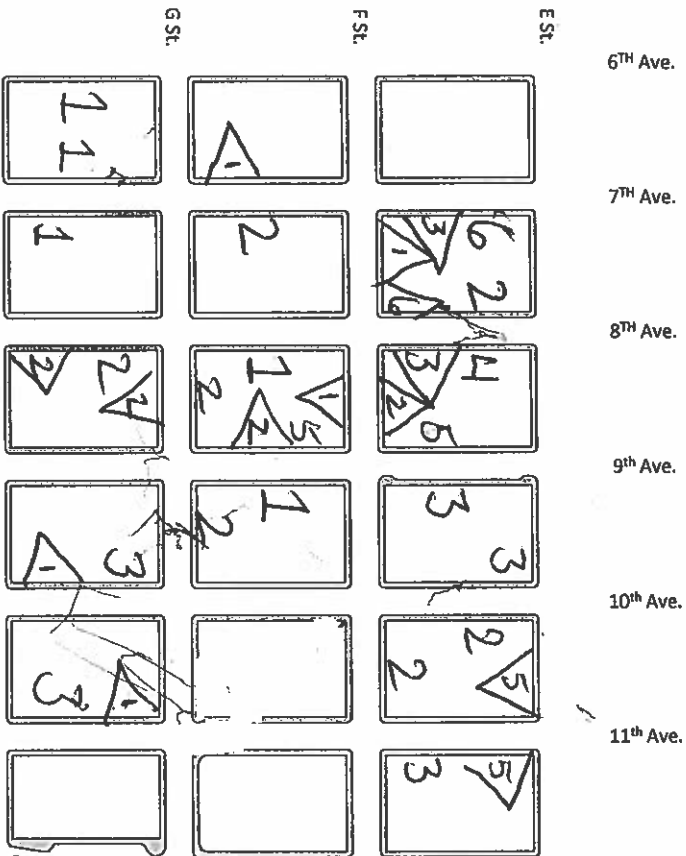

*On May 31, 2018 the Clean & Safe program adopted the methodology used by the Regional Task Force on the Homeless to count homeless individuals. Per the methodology, Clean & Safe staff will count 1.75 individuals per visible tent/structure and 2.03 individuals per vehicle that shows clear signs of habitation.



= 2.03 homeless individuals in vehicles
 = 1.75 homeless individuals in tents/hand-made structures

Trolley Line

East Village South 12AM-5AM



Downtown Fellowship of Churches & Ministries

Date: 12/19/19

Name: *[Handwritten Name]*

Signature: *[Handwritten Signature]*

Temperature: 48

Rain: Yes/No

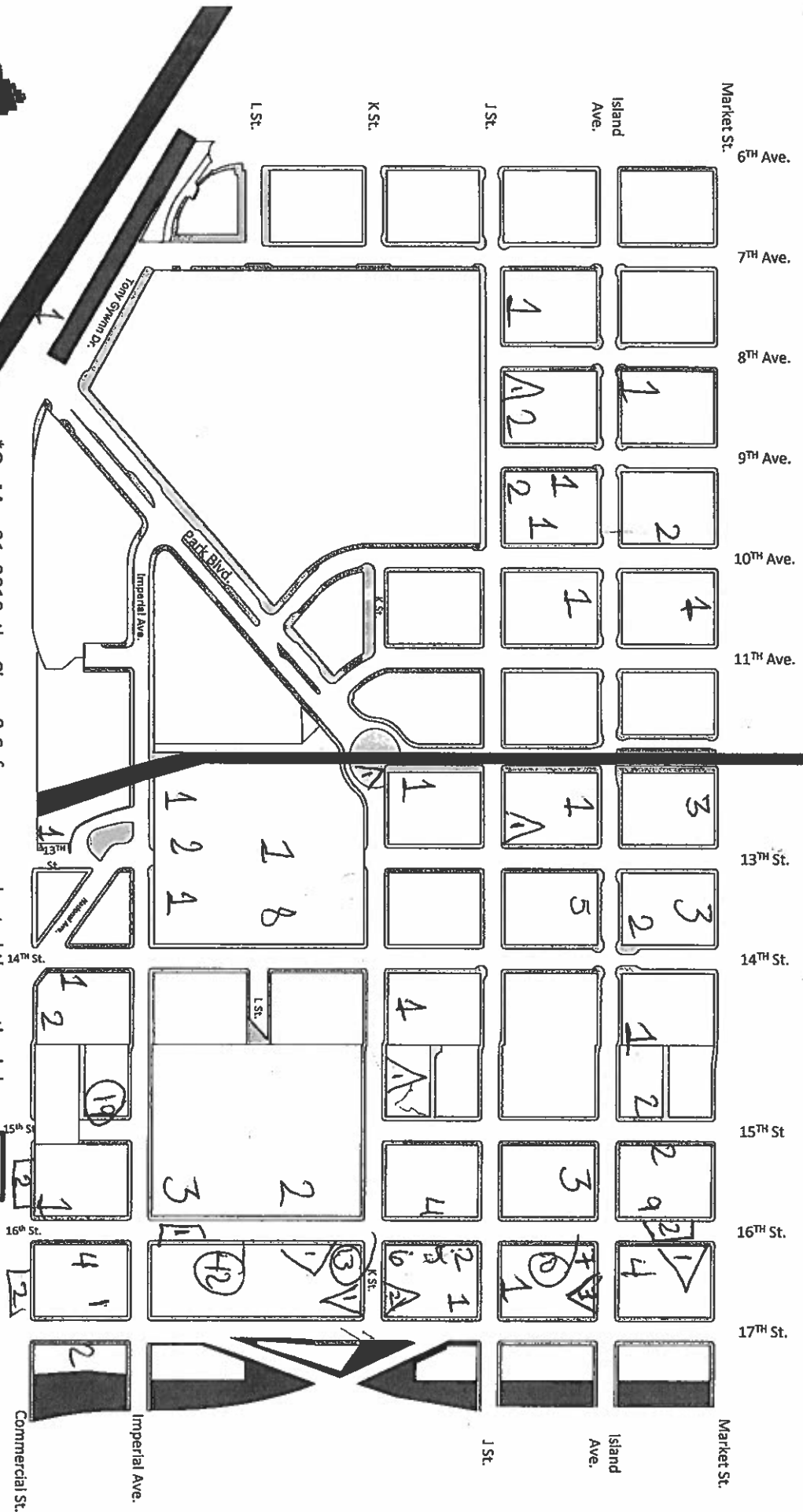

*On May 31, 2018, the Clean & Safe program adopted the methodology used by the Regional Task Force on the Homeless to count homeless individuals. Per the methodology, Clean & Safe staff will count 1.75 individuals per visible tent/structure and 2.03 individuals per vehicle that shows clear signs of habitation.

- = 1.75 homeless individuals in tents/hand-made structures
- = 2.03 homeless individuals in vehicles



City Center
12AM-5AM



Downtown Fellowship of

Churches & Ministries

Date: 12/19/19

Name: R. Velthuis

Signature: [Signature]

Temperature: 48°

Rain: Yes/No No

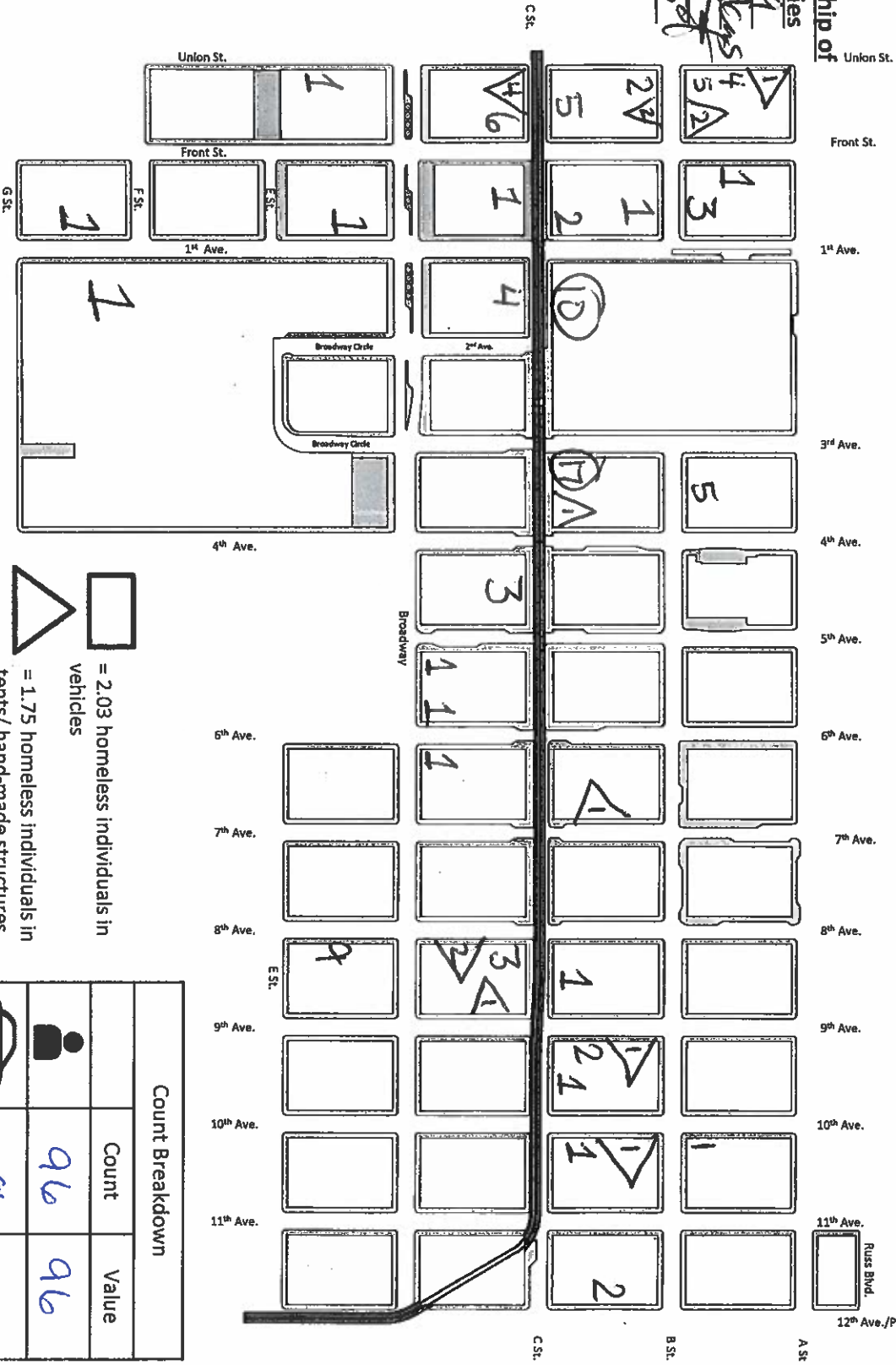

*On May 31, 2018, the Clean & Safe program adopted the methodology used by the Regional Task Force on the Homeless to count homeless individuals. Per the methodology, Clean & Safe staff will count 1.75 individuals per visible tent/structure and 2.03 individuals per vehicle that shows clear signs of habitation.

Count Breakdown	
Count	Value
	96
	0
	0
Total	124



Columbia

12AM-5AM

Downtown Fellowship of Churches & Ministries

Date: 12/19/19

Name: *Police Officers*

Signature: *[Signature]*

Temperature: 48°

Rain: Yes/No

Count Breakdown		Count	Value
		36	36
		0	0
		3	5.25
Total			41.25

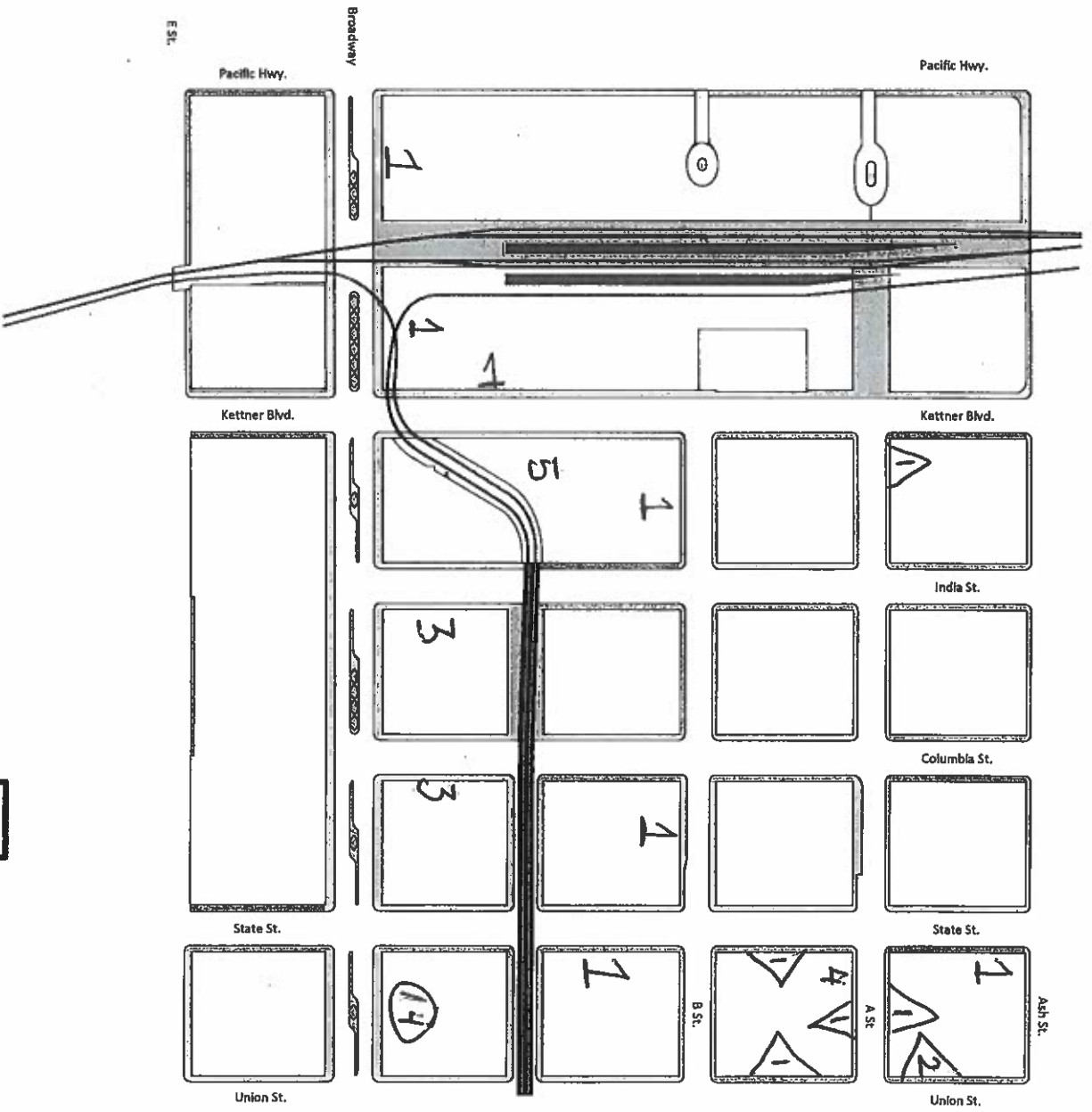

*On May 31, 2018, the Clean & Safe program adopted the methodology used by the Regional Task Force on the Homeless to count homeless individuals. Per the methodology, Clean & Safe staff will count 1.75 individuals per visible tent/structure and 2.03 individuals per vehicle that shows clear signs of habitation.





Marina
12AM-5AM
 Downtown Fellowship of
 Churches & Ministries

Date: 12/9/19
 Name: Lisa Steier
 Signature: [Signature]
 Temperature: 98°
 Rain: Yes/No

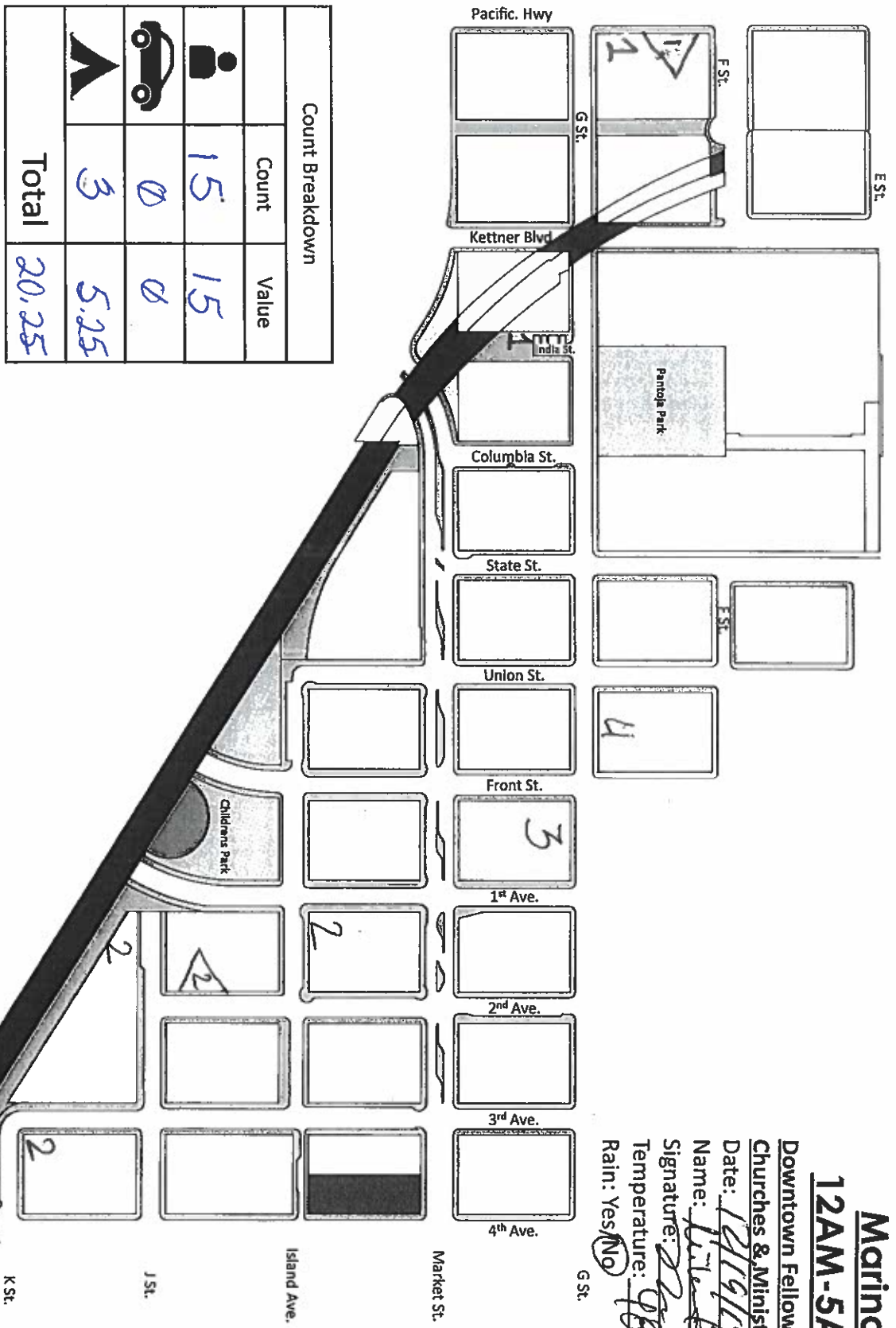

*On May 31, 2018 the Clean & Safe program adopted the methodology used by the Regional Task Force on the Homeless to count homeless individuals. Per the methodology, Clean & Safe staff will count 1.75 individuals per visible tent/structure and 2.03 individuals per vehicle that shows clear signs of habitation.

- = 2.03 homeless individuals in vehicles
- = 1.75 homeless individuals in tents/hand-made structures





Downtown Fellowship of Churches & Ministries

Date: 11/11/19

Name: Mike Stephens

Signature: *Mike Stephens*

Temperature: 68

Rain: Yes/No

Count Breakdown		Count	Value
		26	26
		0	0
		6	10.5
Total			36.5

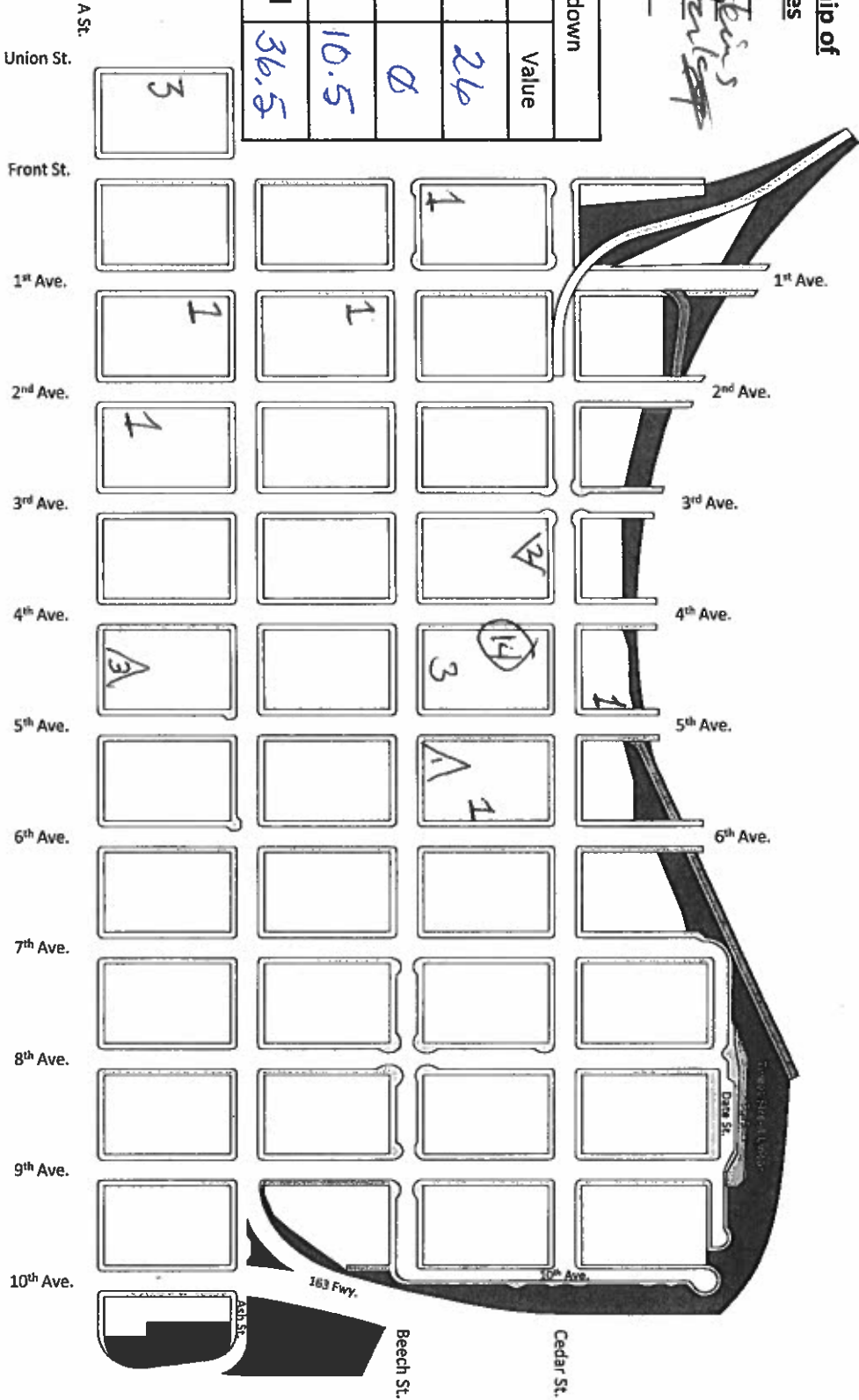

*On May 31, 2018, the Clean & Safe program adopted the methodology used by the Regional Task Force on the Homeless to count homeless individuals. Per the methodology, Clean & Safe staff will count 1.75 individuals per visible tent/structure and 2.03 individuals per vehicle that shows clear signs of habitation.

= 2.03 homeless individuals in vehicles
 = 1.75 homeless individuals in tents/hand-made structures



Gaslamp 12AM-5AM



Downtown Fellowship of

Churches & Ministries

Date: 12/19/19

Name: *Victor Perkins*

Signature: *[Signature]*

Temperature: 40

Rain: Yes/No

Count Breakdown		Count	Value
		33	33
		0	0
		1	1.75
Total			34.75



= 2.03 homeless individuals in vehicles



= 1.75 homeless individuals in tents/hand-made structures



	4 th Ave.	5 th Ave.	6 th Ave.
Broadway	5 1	2	
E St.	1	1	
F St.			8
G St.		2	
Market St.	1 1 2	1	
Island Ave.			
J St.	1		
K St.		1	
L St.		3 2	

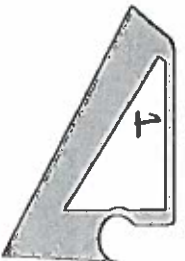

*On May 31, 2018 the Clean & Safe program adopted the methodology used by the Regional Task Force on the Homeless to count homeless individuals. Per the methodology, Clean & Safe staff will count 1.75 individuals per visible tent/structure and 2.03 individuals per vehicle that shows clear signs of habitation.



Harbor Dr.